

Winter 2023

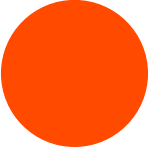



Innovation.
Collaboration.
Co-creation.



CONTENTS

Letter From the Executive Director	1
At a Glance	2
People.....	4
Impacts.....	6
Design Assistance	9
Capacity Building.....	15
Financial Support	20
Looking Ahead.....	22



Volunteer planting day in Five Points with Green Dot Coalition

LETTER FROM THE EXECUTIVE DIRECTOR



Dear Friends,

For more than 20 years Design Workshop (DW) Foundation has been committed to advancing our vision of cultivating empowered and thriving communities for future generations. Determined to go beyond traditional grantmaking activities, we've taken a fresh approach and have become an organization that communities can look to as a source for catalytic ideas, technical support, and partnership. To celebrate our work co-creating equitable, resilient and inclusive places, we developed our first-ever DW Foundation Impact Report which details our projects and results from the past two years.

In 2022, we announced our newly appointed Board of Trustees and I took on the role of the Foundation's first full-time executive director. It is an honor to carry on the Foundation's mission while expanding our reach to new communities. This past year was a pivotal year for us. We kicked off our inaugural Community Capacity Building Initiative, a technical assistance effort to support under-resourced communities in overcoming built environment challenges. DW Foundation's Capacity Building work has touched both urban and rural communities across the U.S., and our project teams have co-created ideas and solutions that will result in lasting positive change.

We are grateful to our partners and supporters for your trust in our work and mission. Your support has been the driving force behind our success. As we look to 2024, we are filled with excitement to deepen alliances that will bolster and amplify our impact. We can't wait to embark on new initiatives that will shape vibrant and inclusive communities—we hope you join us on our journey ahead.

Sincerely,

A handwritten signature in black ink that reads "Sarah Konradi". The signature is written in a cursive, flowing style.

Sarah Konradi

AT A GLANCE // a fresh look



Design Workshop Foundation:

Supported **4 community-driven projects** across **3 states**. We built momentum for projects advancing parks and open space, green infrastructure, and climate resilience.

Collaborated with **15 partner organizations**.

Provided over **1,300 hours of in-kind services** to our project partners, helping to leverage nearly **\$500,000 in implementation funds** for communities.

Engaged **16 Interns** in social impact projects.

1,300
hours of in-kind
services since
2022

15
partner
organizations

Mission

Design Workshop Foundation works in service to communities to catalyze transformative change through design assistance, capacity building and education.

Vision

Empowered and thriving communities for future generations.

Values

Innovation. Collaboration. Co-creation.

Goals

- Advance social, economic and environmental equity in the lived environment.
- Build community resilience and adaptation.
- Diversify perspectives in design and planning.

PEOPLE

BOARD OF TRUSTEES



Sarah Konradi



Chris Geddes



Tarana Hafiz



Emily McCoy



Alison Bourquin



Carolyn Levine



Ben Fish



Ashley Hejtmanek



Mo Bachtiar



Grace Tice

CHAMPIONS



Julia Prince



Sam Daniel



Kristin Witte



Adeline Lerner



Peter Samuels



Reilly Thimons



PROJECT TEAMS

Thank you to the following Design Workshop employee-owners who served on DW Foundation project teams:

Feras Abdallah	Ashley Hejtmanek	Emma Potter
Olha Antsyferova	Cheryl Huffman	Amira Slocum
Laura Bachinsky	Sarah Konradi	Paul Squadrito
Brian Chambers	Eric Krohngold	Grace Tice
Shaoyu Chen	Brenna Laffey	Jason Toussaint
Bryan Cueva	Anna Laybourn	Christian Weber
Corey Dodd	Sasha Mathieu	Alex Zarookian
Jessica Garrow	Emily McCoy	Urey Zhuang
Ishita Ghosh	Lindsey Naylor	
Tarana Hafiz	Emily Pixberg	

Dr. Charles Fountain Interns:

2022

Christian Galindo
Selah Grant
Ciara Knight
Gauri Patel
Eneyda Salcedo
Dylan Smith
Ivan Vazquez

2023

Jaime Andrade
Brittany Angell
Faith Charles
Bryan Cueva
Ketaki Ghodke
Ogheneruno Okotie
Brenda Rodriguez
Eneyda Salcedo
Amira Slocum

IMPACTS

2022
2021
2020



AUGUST '22
Board of Trustees appointed.

OCTOBER '22
Strategic Initiatives established.

JUNE '22
Greening Five Points **Design Assistance** completed.

*"DW Foundation projects have the potential to encourage environmental stewardship, promote greater diversity and representation in our field, and unite the firm in doing meaningful work- **let's do this!**"*

APRIL '22
Executive Director **Sarah Konradi** hired.



MISSION VISION VALUES

DECEMBER '22
First annual Design Workshop **Employee-Owner giving campaign.**

JANUARY '23
DW Foundation **website and social media** channels launched.

Design Workshop, Inc. Board of Directors voted to relaunch the **DW Foundation.**



MARCH '23
Community Capacity Building National Request for Applications released.

JUNE '23
Selected **Capacity Building** projects announced.



**FOUNDATIONS
OF THE FOUNDATION
2003**

2023



LOOKING AHEAD

NOVEMBER '23
Aspen Camp for the Deaf and Hard of Hearing Master Plan project kicks off.

OCTOBER '23
Design Workshop Foundation and Green Dot Coalition partners awarded **EPA environmental justice grant.**

OCTOBER '23
DW Foundation partnered with ASLA for **Dream Big with Design.**

OCTOBER '23
Inaugural DW Foundation **fundraising event** in Denver.



JULY '23
Two additional **Board of Trustees** members appointed.

JUNE '23
Hive Park **Design Assistance** project in collaboration with DW Dr. Charles Fountain internship began.

JUNE '23
Kinston Teens project kicked off.



JUNE '23
Northeast Houston Redevelopment Council project kicked off.

THE DIRT

Uniting the Built and Natural Environments

Apply Today: Design Workshop Foundation Community Capacity Building Initiative

05/11/2023 | Jared Green







DESIGN ASSISTANCE

Imagine if we accelerated equitable access to healthy, resilient community spaces. Design Assistance bridges the gap between vision and implementation of projects for historically under-resourced and untapped communities. This collaborative model engages the Design Workshop Dr. Charles Fountain interns, a diverse team of students from across the country, in support of a community-driven site design project.

Design Assistance Partners

Green Dot Coalition	Make a Chess Move
Green Spaces	Urban Sanctuary
National Wildlife Federation	The Hive House
Aspen Camp of the Deaf and Hard of Hearing	Lewiston Woodville Educational Vitality Center
Birdseed Collective	NCSU Just Communities Lab

GREENING FIVE POINTS

The Green Dot Coalition, an equity-focused placemaking organization, requested support from the DW Foundation to advance their community engagement efforts in Denver's Five Points neighborhood which faces built environment challenges resulting from discriminatory redlining, years of disinvestment, and climate change.

The DW Foundation and a team of Dr. Charles Fountain interns collaborated with the Green Dot Coalition to develop a green infrastructure toolkit, called "Greening Five Points," in support of the community-led, equity-focused urban greening effort. The toolkit communicates and advocates for the value of green infrastructure, validates residents' stories of lived experience with data and analysis, and identifies priority improvements to maximize the Coalition's limited resources.

DW Foundation's support for the Green Dot Coalition will continue in 2024 to support implementation and planning efforts for Greening Five Points, and will help engage the neighborhood in improvements that will provide dramatic and lasting environmental, social and climate resilience benefits.



DW Foundation's partners are **building momentum**:



In-kind match of support for **EPA Environmental Justice Grant** (awarded November 2023)

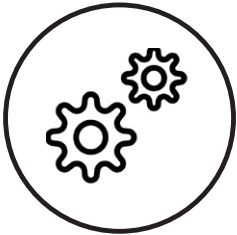

Technical assistance for **small business owners**



Ongoing support for **fundraising and advocacy**

“The partnership with Design Workshop Foundation and the Dr. Charles Fountain interns helped take this project to the next level. We now have materials to engage and inspire the community around this project.”

Green Dot Coalition Member



PARTNER SPOTLIGHT: JEVON TAYLOR

Co-Founder, Green Dot Coalition

Jevon Taylor is the Co-Founder of the Green Dot Coalition and CEO of Green Spaces, a co-working, incubator marketplace and event space in Denver's RiNO neighborhood that supports creatives, entrepreneurs and non-profits through lenses of social impact and economic sustainability. A Denver native, Jevon's main passions lie in diversifying his impact within the Denver community by providing a platform to amplify the voices of local creators, spearheading various community development, environmental and educational programs.

Outside of running Green Spaces, Jevon has worked within multiple urban farming organizations, school districts, and now serves on various boards including the RiNo Art District's Business Improvement District Board. Jevon's main goal is to cultivate sustainable growth and positive change across the city for future generations.

THE HIVE PARK

The small, tightly knit rural community of Lewiston Woodville, North Carolina worked with a diverse team to give shape to an ambitious vision: The Hive Park.

Like many rural towns in the South, Lewiston Woodville enjoyed 20th century growth, only to be abandoned by industries that had provided stability. Worsening job prospects, social isolation and health and well-being issues underscore Lewiston Woodville's need for a shared open space or park.

The Hive Park was fueled from the beginning by its leaders, including the town matriarch, a respected minister and an environmental justice advocate. The site donated for the park is centrally located and surrounded by a supportive network of faith-based and youth empowerment organizations.

The engagement process led by the Design Workshop Dr. Charles Fountain Interns revealed that community members who had never had a public park of their own simply wanted a place to be together outdoors. A grassroots vision highlights the town's rich history and community, supports healthy living and restores native ecologies to create a park for all.

The park concept plan developed by the Design Workshop Dr. Charles Fountain Intern team in partnership with DW Foundation provides simple and accessible paths and spaces for the entire town, including young children, families, teens and seniors alike. The programming and stewardship vision engages local partners to foster community, celebrate diversity, and support shared park maintenance.

Local and national partners, donors and supporters are advancing the vision for The Hive Park so that construction can begin in 2024.

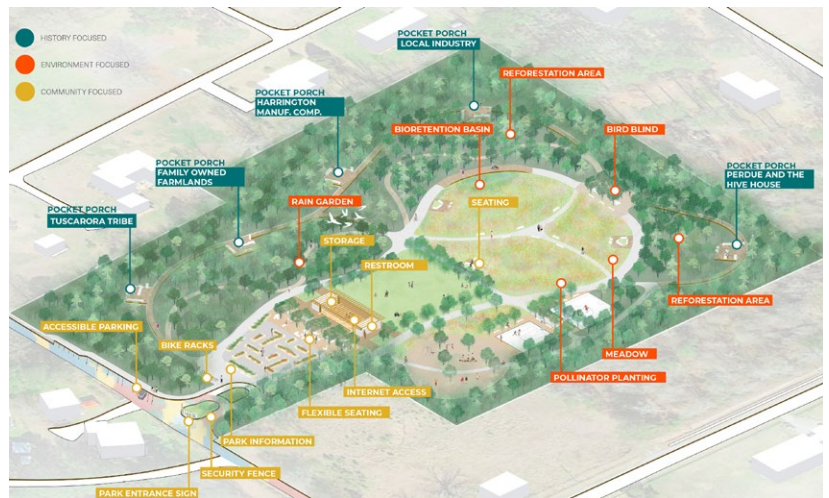

DW Foundation's partners have **big plans**:



\$500,000 Goal for grants and in-kind support to **build out the park** by 2027



4+ Local churches and organizations supporting the **development of The Hive Park**

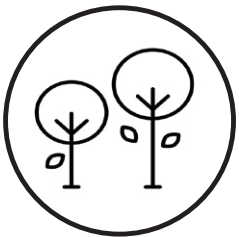

8+ **New destinations** along the trail network

"My community's best resource is people. That is what drives me to action."

Vivian Saunders,
*Founder, Hive House
and Vitality Center*



PARTNER SPOTLIGHT: VIVIAN SAUNDERS

Founder, Hive House and Vitality Center

Vivian Saunders is Director of the Hive House, a nonprofit community center and afterschool program in rural Bertie County, North Carolina. Her love for children drove her to quit her job at Perdue Inc. and pursue her passion to serve the community by opening the first 24-hour child care center. Years later, Saunders expanded her child-focused mission by installing and administering two technology community centers in Bertie County and served over 100 students at the Hive, an alternative school for young men in 6th through 12th grades.

Saunders' work reached national and international recognition when her story was depicted in the film *In the Hive*, starring Loretta Devine, Michael Clark Duncan, and Vivica Fox. "The best way to get things accomplished in my community is to be honest and respectful," says Saunders. "I don't see myself as the person that should get the glory for the job. I am the person that gets the job done." She was formally educated at Fayetteville State University and Martin Community College.



A young woman with long braids is looking down at a map or document. She is wearing a white t-shirt with 'KINSTON TEENS' printed on it. In the background, there are signs for 'KINSTON TEENS' and 'EAST KINSTON OPPORTUNITIES MAP'.

CAPACITY BUILDING

Imagine if historically under-resourced communities could chart paths to a sustainable future. Capacity building is an investment in the future health of a community. DW Foundation's capacity building initiative brings people together to prioritize problems, look for attainable solutions and craft plans for meaningful first steps that build momentum towards larger goals.

This effort, launched through a national Request for Applications in 2023, addresses the systemic under-funding of public projects in historically under-represented communities and provides no-cost support for community teams.

Capacity Building Partners

Kinston Teens, Inc.

NCSU Just
Communities Lab

NC Climate Justice
Collaborative

Northeast Houston
Collaborative

Northeast Houston
Redevelopment
Council

The Hive Fund for
Climate and Gender
Justice

KINSTON TEENS EQUITABLE DEVELOPMENT PLAN

Kinston Teens, Inc. is a nonprofit organization with a mission of empowering young people through service, leadership, and civic engagement. They lead efforts in voter registration and engagement, leadership skills training, community development, and crisis response. Their organization operates primarily in Kinston's East Kinston neighborhood, the focus for this capacity building opportunity. East Kinston is considered to be the most economically disadvantaged census tract in the state of North Carolina.

The Just Communities Lab is a program of North Carolina State University that focuses on landscape strategies to advance social equity and environmental justice in communities. The Just Communities Lab addresses equity both in the work it takes on and the researchers and students it recruits.

DW Foundation supported visioning for a vibrant, healthy, beautiful, connected, resilient and restored East Kinston. The plan is being shaped through community feedback, historical development analysis and facilitated conversations with stakeholders. DW Foundation is helping build equitable opportunities in East Kinston by co-developing concrete strategies in real estate, organizational growth programming and partnerships.

The Equitable Development Plan focuses on actionable strategies for Kinston Teens and highlights 'big moves' requiring leadership from other entities to support the community-driven vision.



Images above by Aniya Bourne, Bourne to Film

DW Foundation's partners are redefining community resilience:

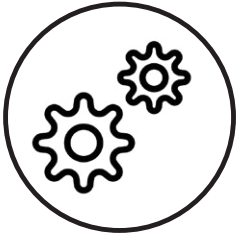

150+
Workshop attendees

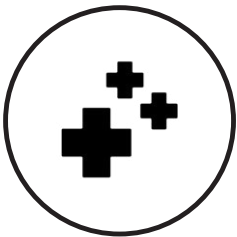

6 Community
workshops and focus groups



189 Survey
responses

"We believe that this space, combined with our ongoing community development efforts in East Kinston, will serve as a catalyst to building a healthier, and safer neighborhood."

Chris Suggs,
Founder, Kinston Teens



PARTNER SPOTLIGHT: CHRIS SUGGS

Founder, Kinston Teens

Chris is the Founder of Kinston Teens, Inc., a nonprofit organization he started in October 2014 operating at the intersections of youth empowerment and community development. From transforming vacant lots into neighborhood amenities, to building platforms for young people to be involved in government and make their voices heard, Kinston Teens works to ensure that Chris's peers and local community are both thriving. The organization coordinates voter registration efforts, leadership trainings, social events, and more initiatives for young people in Kinston, North Carolina.

Chris's proudest accomplishments in this capacity include helping to change North Carolina's law of prosecuting 16 and 17-year-old non-violent offenders as adults and now allowing them to be serviced under the juvenile justice system, and the implementation of an anonymous school safety reporting app in North Carolina public schools for students to assist in keeping their schools safe.

NORTHEAST HOUSTON REDEVELOPMENT COUNCIL

The NE Houston Redevelopment Council (NEHC) is a lead organization in the Northeast Houston Collaborative which represents 15 community based organizations. The NEHC partners with historically disadvantaged communities in Northeast Houston suffering from impacts of legacy environmental racism and climate change.

The organizations share a vision to ensure a more equitable future for Northeast Houston. The Collaborative member organizations seek to identify and prioritize clean energy, resiliency, and mobility projects in Northeast Houston and to ensure equitable funding at all levels of government.

Five neighborhoods—Kashmere Gardens, Trinity/Houston Gardens, Settegast, Pleasantville, and Greater Fifth Ward—came to form the NE Houston Collaborative in 2023 to pursue a strategy for climate justice. With 57,000 citizens over 20 square miles, the area is majorly impacted by flooding, food insecurity, and insufficient infrastructure.

There are two “Momentum Projects” that have been identified by the Collaborative as key initial priorities, including “Community Resilience Hubs” and “Hub Home Networks.” Community Resilience Hubs will be located at public facilities to serve the larger population, providing solar arrays and battery storage for disaster relief.

The Hub Homes will be a network of houses, each serving twenty neighbors. The houses will be equipped with plumbing and electrical improvements and include supplies to be used for natural disasters. Both of these hub types are planned to be scaled up to create lasting benefits for the community.

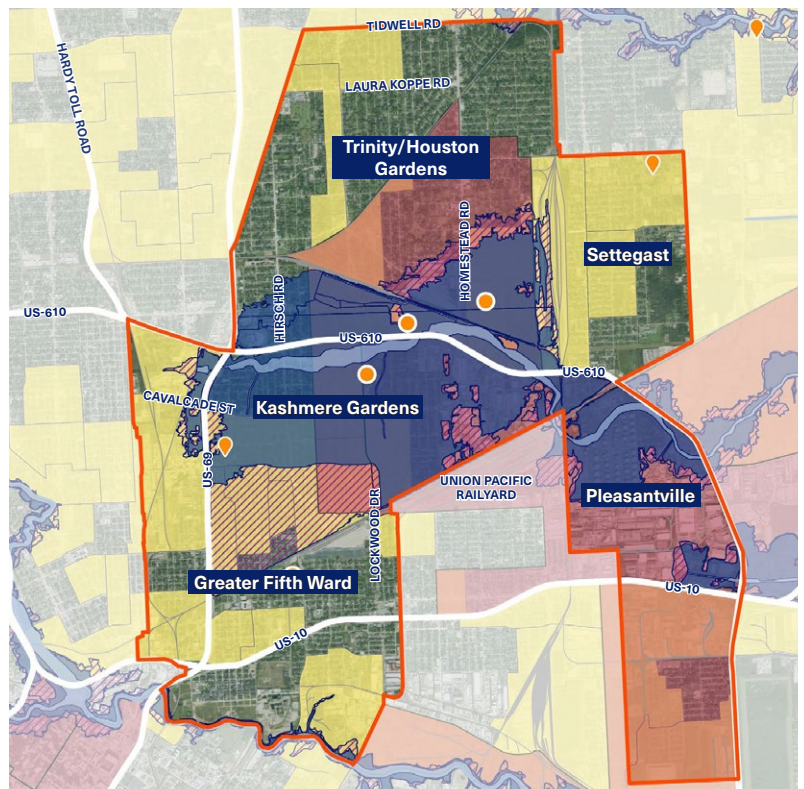
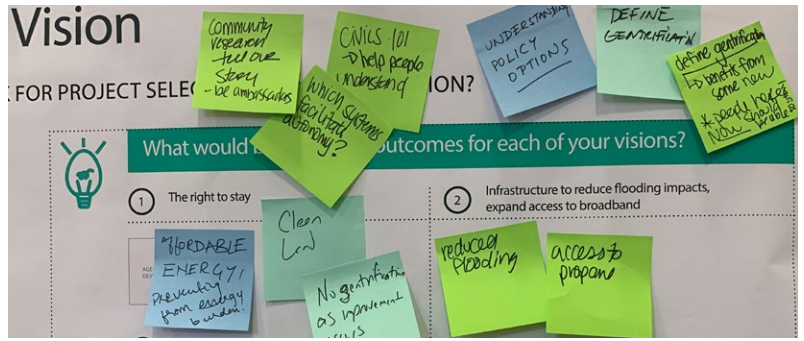

- LEGEND**
- STUDY AREA
 - HIGHEST NATIONAL RISK INDEX TRACTS
 - 65 ABOVE AGE - VULNERABLE POPULATION
 - 500-YEAR FLOOD AREA
 - 100-YEAR FLOOD AREA
 - FLOODWAY
 - RESILIENCY HUB CENTERS
 - SOLAR HUB HOUSES
 - WATER FEATURES
 - RAILWAY

Our partners are working to overcome systemic barriers:

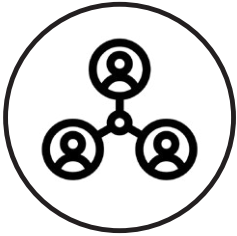

15 Community partners

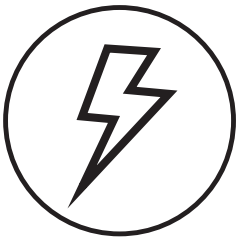

Ranks above the national **90th percentile** energy costs



Ranks above the national **90th percentile** for proximity to Superfund sites

“We have been working on-the-ground in Houston neighborhoods for many years but recently have aligned with other grassroots organizations to maximize our impact in the areas of resilience, food security, education and energy.”

Huey Wilson,
Executive Director, Northeast Houston
Redevelopment Council



PARTNER SPOTLIGHT: HUEY WILSON

Huey is currently working with several community organizations including serving as president of Super Neighborhood



48-Trinity/Houston Gardens, Kashmere Feeder Pattern Community Council, Keep Houston Beautiful-Commissioner, and she is one of the founding directors of Northeast Houston Redevelopment Council. In her work with NEHRC she has led multiple partnerships to achieve a Resilience HUB/Lilypad to ensure neighbors in Northeast Houston are ready for the next disaster.

She continues to work on a more resilient community after Hurricane Harvey through her efforts with Local Initiatives Support Corporation (LISC), University of Houston, Texas Southern University, and Rice University, to name a few.

FINANCIAL SUPPORT

Thank you to our donors and partners who have fueled our efforts to create impact through design, planning and placemaking. Your support has helped us to meet communities where they are and grow our initiatives and partnerships.

Design Workshop Foundation is sponsored by Design Workshop, Inc., and to date the firm has provided over 1,300 hours of in-kind design support to community projects across the country.



83%

income
growth from
2021 to 2023

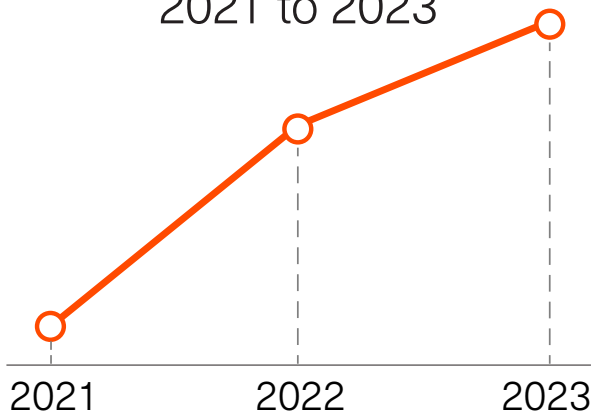

59

individual gifts from
Design Workshop
employee-owners
and external donors

DONATION AMOUNT	NUMBER OF DONATIONS
<\$101	38
\$101 - \$999	15
\$1000+	6

LOOKING AHEAD

The DW Foundation 2024 strategic plan sets forth the goals and strategies that will guide the Board of Trustees, Design Workshop staff, and volunteers over the next five years as we engage with communities through time, talent, and resources. Here's a sneak peek.



PROGRAMS

**Deliver Impactful
Projects & Programs**

Engage and Educate

**Grow Strong
Partnerships**

PARTNERSHIPS



COMMUNICATIONS

**Create
Ambassadors**

**Provide a Platform for
Community Voices
and Stories**



24

**Raise Funds for
Capacity and
Sustainability**



CAPACITY

**Strategically Leverage
Design Workshop Resources**



Contact

✉ info@designworkshopfoundation.com

🌐 <https://www.designworkshop.com/dwfoundation>

📷 <https://www.instagram.com/designworkshopfoundation/>

in <https://www.linkedin.com/company/design-workshop-foundation>



venmo



PayPal